

Linking to Atlas from Canvas

1. Navigate to the Modules section of your Canvas Course

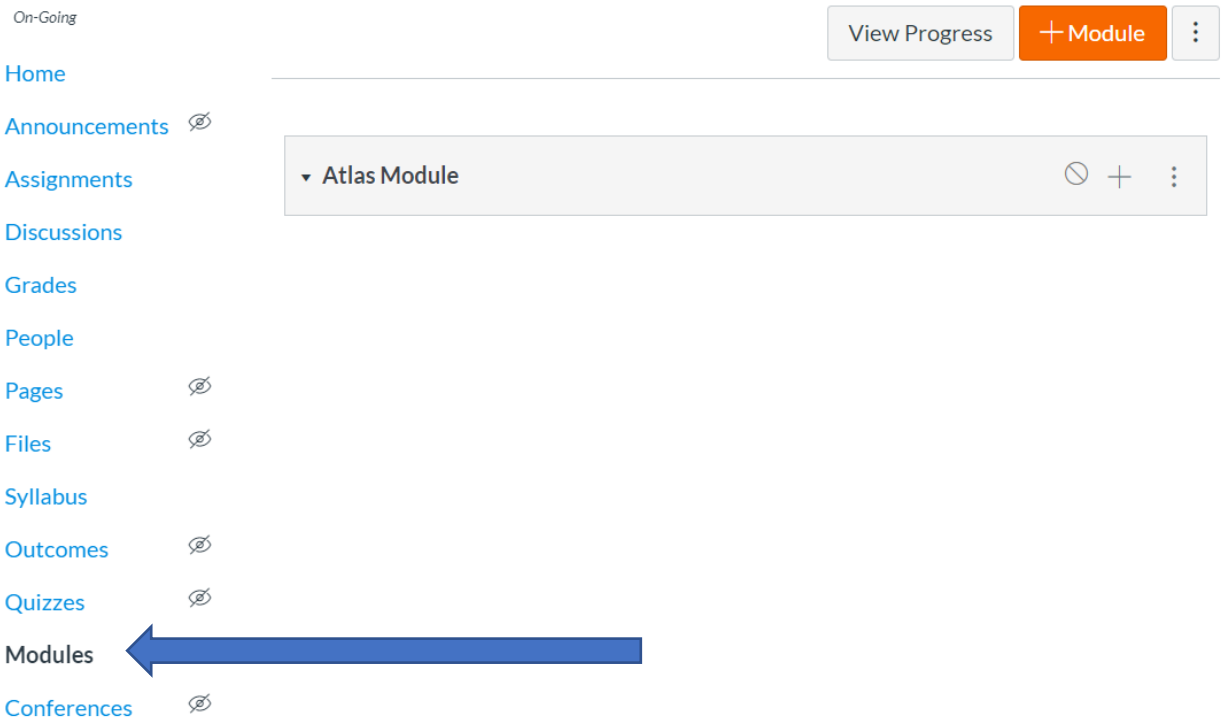

2. Click the grey + button next to the Module Heading to add a new item to the Module

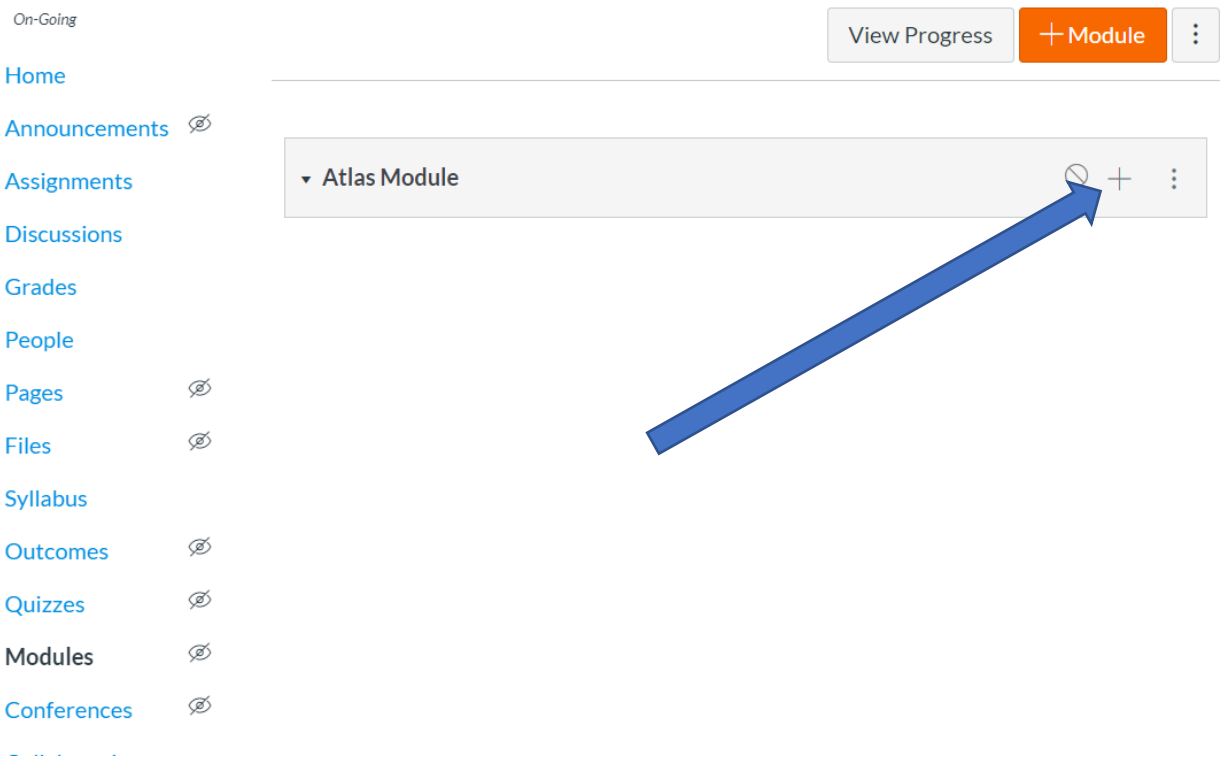

3. Select "External Tool" from the drop-down list of item types

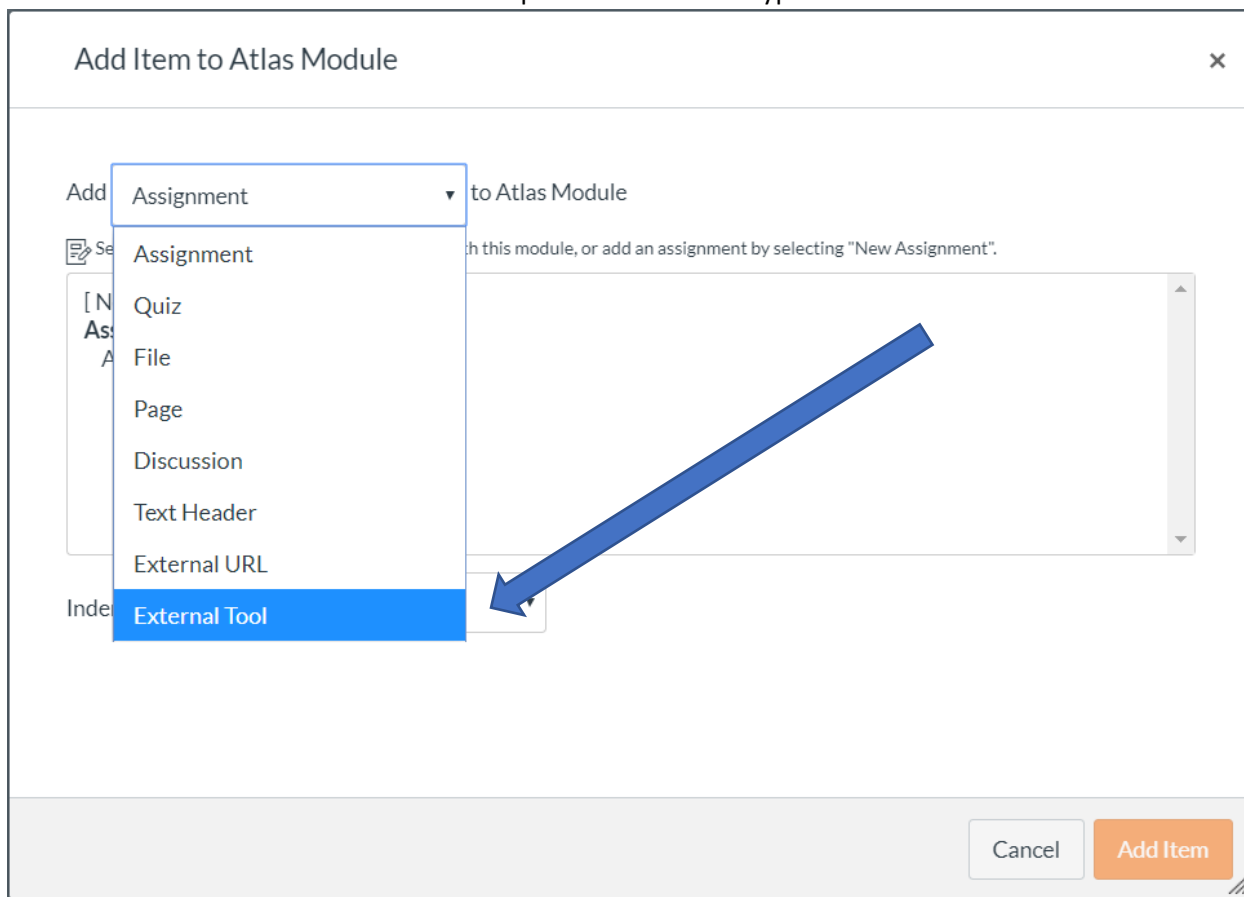

4. Select the ATLAS LTI Tool from the drop-down menu of available tools

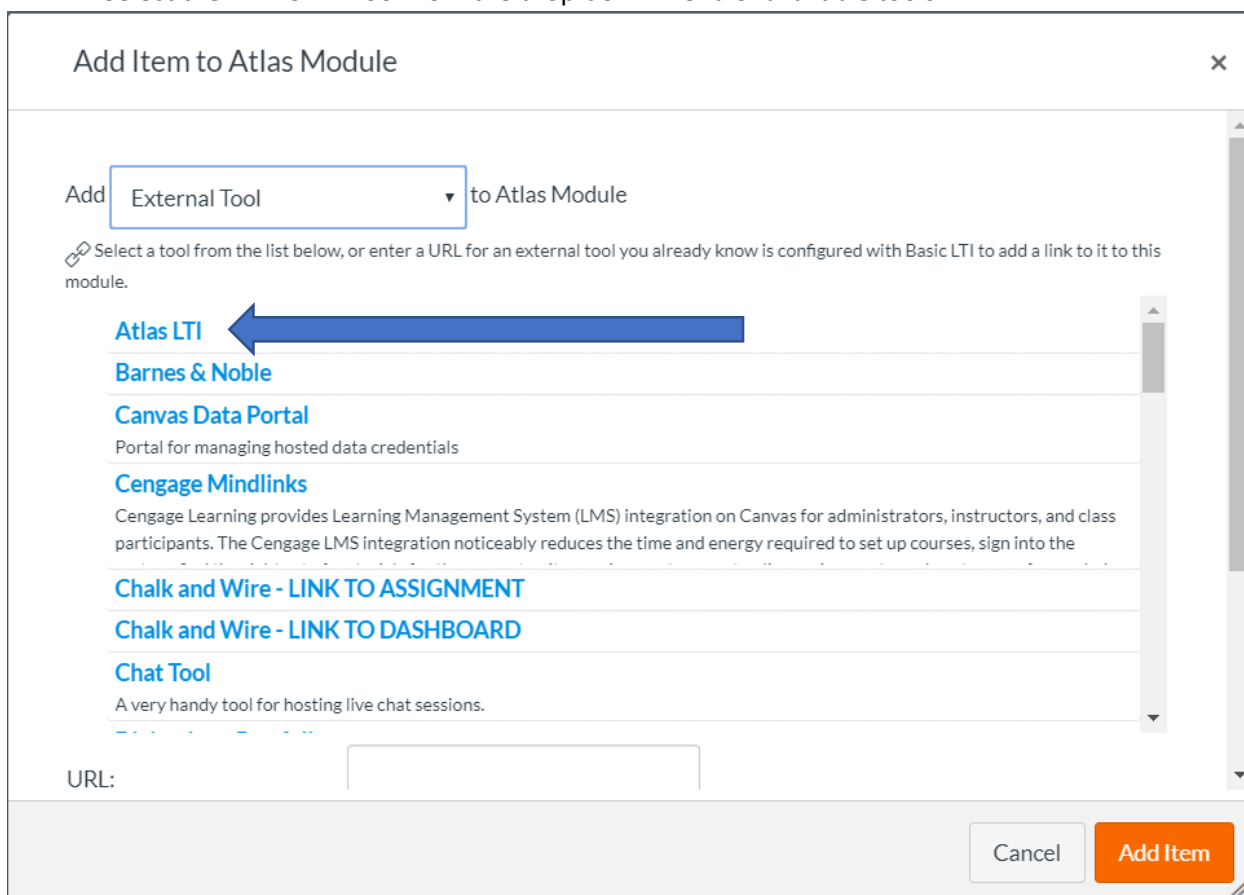

5. Use the outermost scrollbar on the pop-up window to scroll down a bit; name your new page

Add Item to Atlas Module ✕

Select a tool from the list below, or enter a URL for an external tool you already know is configured with Basic LTI to add a link to it to this module.

- Research & Adopt Course Materials**
- Roll Call**
A very handy tool for creating seating charts and keeping track of attendance.
- SoftChalk Cloud**
- Turnitin**
- Turnitin Framework**
Unavailable for use as external tool
- W. W. Norton**
- YouTube**
Search publicly available YouTube videos. A new icon will show up in your course rich editor letting you search YouTube and click to embed videos in your course material.
- Zoom**

URL:

Page Name:

6. Click the orange "Add Item" button

Add Item to Atlas Module ✕

Add to Atlas Module

Select a tool from the list below, or enter a URL for an external tool you already know is configured with Basic LTI to add a link to it to this module.

- Atlas LTI**
- Barnes & Noble**
- Canvas Data Portal**
Portal for managing hosted data credentials
- Cengage Mindlinks**
Cengage Learning provides Learning Management System (LMS) integration on Canvas for administrators, instructors, and class participants. The Cengage LMS integration noticeably reduces the time and energy required to set up courses, sign into the
- Chalk and Wire - LINK TO ASSIGNMENT**
- Chalk and Wire - LINK TO DASHBOARD**
- Chat Tool**
A very handy tool for hosting live chat sessions.

URL:

Select an ATLAS Case to Embed

1. Click on the ATLAS LTI Link you just added to your Module

The screenshot shows a course interface. At the top right, there are buttons for 'View Progress' and '+ Module'. On the left is a navigation menu with items like Home, Announcements, Assignments, Discussions, Grades, People, Pages, Files, Syllabus, Outcomes, Quizzes, and Modules. The main content area shows a module titled 'Atlas Module' with a sub-item 'My New Atlas Page'. A blue arrow points to the 'My New Atlas Page' item.

2. If prompted, login to your ATLAS account
3. Find the case you want to embed and click "Attach LTI Link"

The screenshot shows the 'All Cases' page. At the top, there are buttons for 'All Cases' and 'ATLAS Admins'. A search bar is present. Below is a list of cases with thumbnails and titles. The first case is 'Activating Background Knowledge About Force and Motion - Case 1836'. The 'Attach LTI Link' button for this case is highlighted with an orange box, and an orange arrow points to it. Other cases listed include 'Activating Prior Knowledge About Functions - Case 993', 'Analyzing Data to Determine Investigation Results - Case 243', and 'Analyzing "The Hunger Games" and Making Connections to Real-World Events During a Whole Class Discussion - Case 859'.

4. You are finished! The ATLAS case is now accessible to your students